

## Print a report:

Printing problems? Contact: [linda.weaver@dshs.wa.gov](mailto:linda.weaver@dshs.wa.gov)

First **Export** to Adobe PDF, and then **Print** from the PDF File menu:

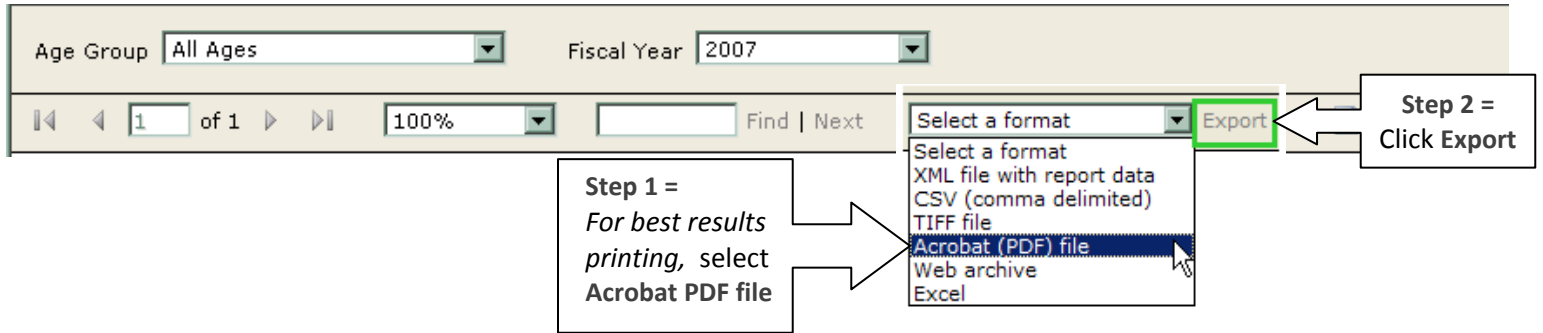

When the File Download prompt appears, you may **Open** or **Save** the PDF file.

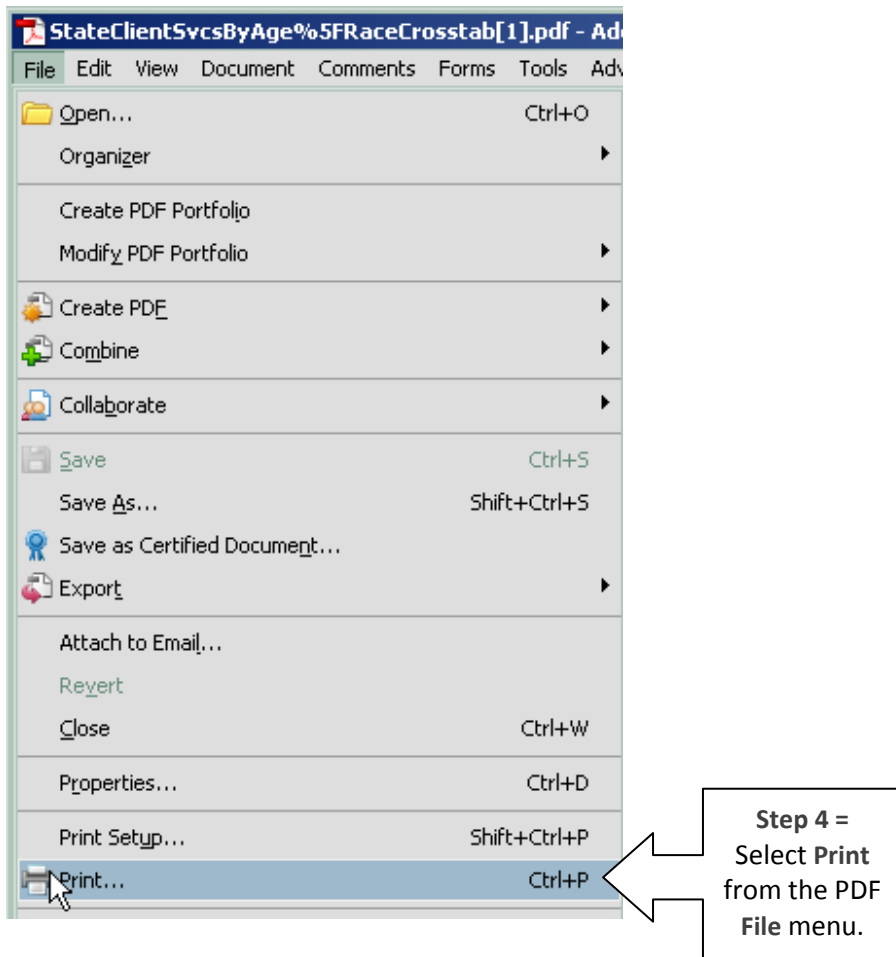
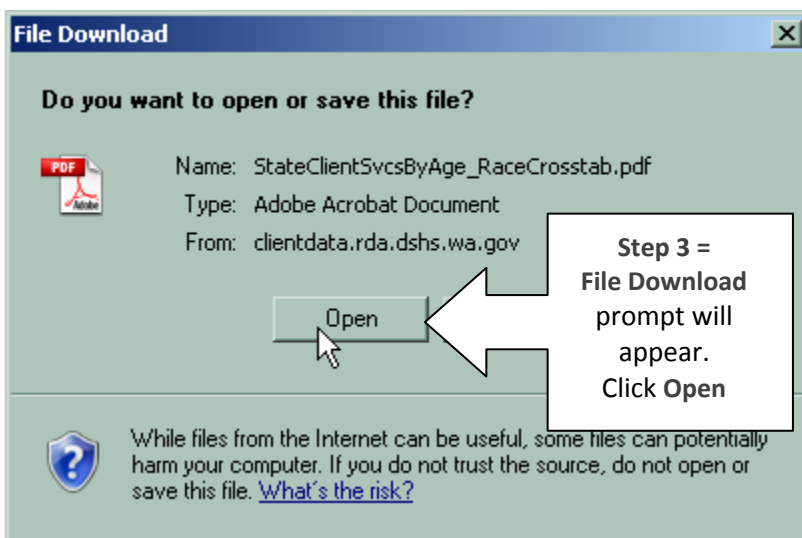

We recommend making sure that your printer is set to duplex print, if available. You may also save the file if desired.