



**DSHS**  
WASHINGTON STATE  
Department of Social  
and Health Services

# 811 PROPERTIES

**Learn about 811 Units**

## UNIT LOCATIONS

### **Region 2**

Boylston Howell  
Compass Broadview  
Liberty Bank  
Madison at River's Edge  
Santos Place  
Sunset Court

### **Region 3**

Anthem Park  
Billy Frank  
Mt. Angeles View

### **Region 1**

315 W Mission  
Aspen Grove  
El Estero  
Buder Haven  
The Marilee  
Nueva Vista  
Skylstad Haven  
St. Jude's Landing

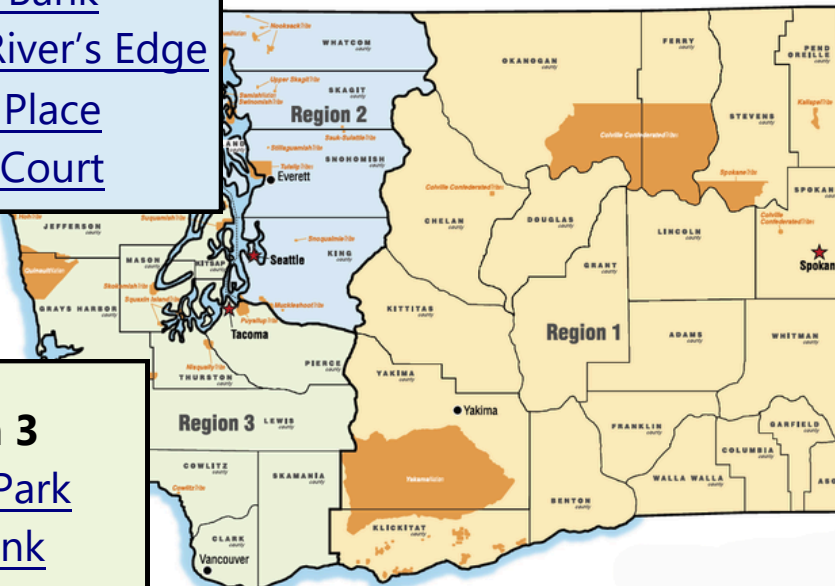

**811  
UNIT**

## **315 W APARTMENTS**

315 W Mission Ave Spokane,  
WA 99201



### **About the Building**

- 3 stories
- 1-bedroom units
  - Eight (8) 811 Units
- Elevator access
- All ADA units
- Major bus line access



### **About the Units**

**Unit size:** Approximately 626 sq. ft.

1 bedroom / 1 bathroom

ADA-friendly

Smoke-free

*\*Example unit in photos; actual unit may vary.*

### **Amenities / Utilities**

- Access to onsite laundry facility
- Sink, stove, refrigerator
- Utilities include water, sewer, garbage
- Tenant pays electricity
- Outdoor green space
- Easy access to bus transit
- Bike storage

### **Pet Policy**

- Only registered service animals and emotional support pets allowed





**811  
UNIT**

## **ANTHEM PARK**

127 W 25th St  
Vancouver, WA 98660



### **About the Building**

- Studios & 1-bedrooms
  - Nine (9) 811 Units
- 4 stories
- Elevator and stairs
- Uptown Village location
- On-site property management



### **About the Units**

#### **Unit sizes:**

Studio: 482 sq. ft.

1-bedroom: 707-708 sq. ft

*\*Example unit in photos; actual unit may vary.*

### **Amenities / Utilities**

- On-site laundry room on each floor
- Dishwasher, refrigerator, stove (no microwave)
- Patio / Balcony
- Portable AC hookups (AC unit not included)
- Water / Sewer / Garbage included

### **Pet Policy**

- Dogs and cats allowed
- 2 Pet Limit
- Weight limit: 25 lbs
- \$300 Deposit / \$200 Fee





# 811 UNIT

## ASPEN GROVE

12204 E 4th Ave  
Spokane, WA 99206



### About the Building

- 1-bedroom Units
  - Ten (10) 811 Units
- 16 stair steps to 2nd floor
- No elevator
- Spokane Valley location



### About the Units

#### Unit sizes:

1-bedroom: 700 sq. ft

*\*Example unit in photos; actual unit may vary.*

Not ADA units.

### Amenities / Utilities

- On-site laundry room open 24 hours
- Dishwasher, refrigerator, stove
- Water / Sewer / Garbage included

### Pet Policy

- Pets allowed with doctor's note
- Emotional Support Animals or Service Animals only





# 811 UNIT

## BILLY FRANK JR. PLACE

318 State Ave NE  
Olympia, WA 98501



### About the Building

- Studios & 1-2 bedrooms
  - Ten (10) 811 Units
- 4 stories
- Elevator access
- 11 ADA units
- Energy efficient



### About the Units

#### Unit sizes:

Range between 415 - 944 sq. ft.

Studios

1-2 bedroom units

*\*Example unit in photos; actual unit may vary.*

### Amenities / Utilities

- Access to free laundry facilities
- Water & garbage included

#### Community Amenity Spaces:

- Kitchen space
- Computer and TV room
- Children's playroom
- Outdoor playground
- Garden

### Pet Policy

- Only registered service animals and emotional support pets allowed





# 811 UNIT

## BOYLSTON HOWELL

1726 Boylston Ave  
Seattle, WA 98122



### About the Building

- Three (8) 811 Units
  - Two (2) studios
  - One (1) 2-Bedroom
- 5 Stories, elevator access
- Recently renovated exterior
- Capitol Hill area



### About the Units

#### Unit Sizes

Studio: 350 sq. ft.

2-Bedroom Unit: 900 sq. ft.

*\*Example unit in photos; actual unit may vary.*

### Amenities / Utilities

- On-site laundry
- Water/Sewer/Garbage included
- Playground Area
- Resident Lounge
- Bike storage
- Resident Services available
- Controlled Access

### Pet Policy

- Pet-Friendly (deposit required)





# 811 UNIT

## BUDER HAVEN & THE MARILEE

201 E. 2nd Ave  
Spokane, WA 99202



### About the Buildings

- Studio & 1-Bedroom
- Buder: (5) 811 Units
- Marilee: (10) 811 Units
- Four stories
- Elevator access
- ADA-friendly units



### About the Units

#### Unit Sizes

Studio: 367 sq. ft.

1-Bedroom Unit: 471 sq. ft.

*\*Example unit in photos; actual unit may vary.*

### Amenities / Utilities

- Coin-operated laundry on each floor
- Stove, Dishwasher, Refrigerator
- Gas/Electric/Water included
- Common meeting areas
- Courtyard areas
- Television rooms

### Pet Policy

- Only Emotional Support Animals and Service Animals allowed



# 811 UNIT

## COMPASS BROADVIEW

147 N 132nd Street  
Seattle, WA 98133



### About the Building

- 3 stories
- Studio & 1-bedroom
  - Eleven (11) 811 Units
- Elevator access
- Secure entry
- Major bus line access



### About the Units

#### Unit sizes:

**Studio:** 431 sq. ft.

**1-bedroom:** 531 sq. ft.

ADA-friendly units

*\*Example unit in photos; actual unit may vary.*

### Amenities / Utilities

- Access to onsite laundry facility
- Community room
- Media room
- Large fenced courtyard and playground
- Water/Sewer/Garbage included
- 2 full-time case managers

### Pet Policy

- Only registered service animals and emotional support pets allowed





# 811 UNIT

## EL ESTERO

2134 E North Crescent Ave  
Spokane, WA 99207



### About the Building

- Studio, 1-2 Bedroom units
  - Six (6) 811 Units
- 3 stories
- ~20 stair steps to 2nd floor
- No elevator

### About the Units

#### Unit sizes:

Studio: 650 sq. ft

1-bedroom: 700 sq. ft

*\*Example unit in photos; actual unit may vary.*

Not ADA units.

### Amenities / Utilities

- On-site laundry for a fee
- Dishwasher, refrigerator, stove
- Water / Sewer / Garbage included
- Assigned parking spot in carport

### Pet Policy

- Pets are allowed

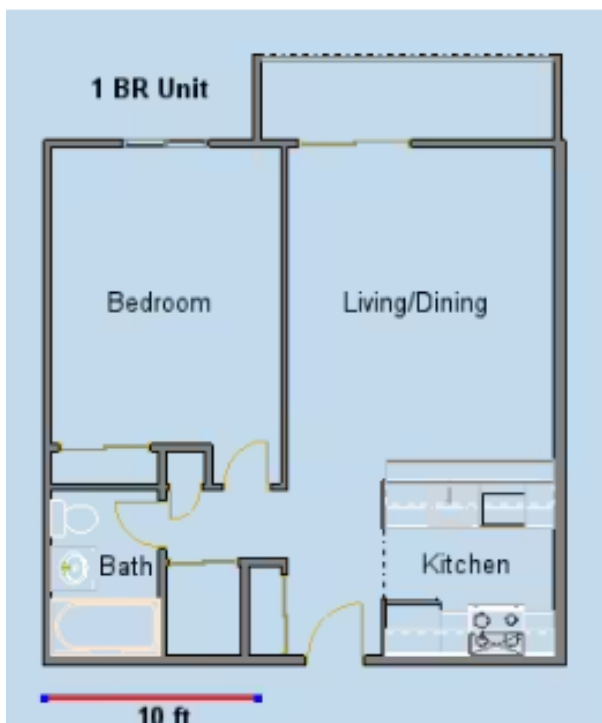

**811  
UNIT**

## **LIBERTY BANK**

1405 24th Ave  
Seattle, WA 98122



### **About the Building**

- Studios & 1-bedrooms
  - Seven (7) 811 Units
- Elevator access
- Central District location
- Secure controlled access



### **About the Units**

Studios or 1-bedroom units (unit sizes vary)

*\*Example unit in photos; actual unit may vary.*

### **Amenities / Utilities**

- On-site laundry
- Sink, stove, dishwasher
- Energy-saving features
- Resident lounge
- Bike storage
- Retail or restaurants in building
- Shared courtyard, BBQ area, and rooftop deck
- Inquire further for specific utilities

### **Pet Policy**

- Pet-friendly
- Fee: 25% of full month's rent





811  
UNIT

## MADISON AT RIVER'S EDGE

1741 22nd St NE  
Auburn, WA 98002



### About the Building

- 2 stories
- 13 stair steps to 2nd floor
- 1-2-3 bedroom units
- Situated by Green River
- *No ADA Units*
- *No elevator*



### About the Units

#### Unit sizes:

1 bedroom / 1 bath: 675 sq. ft.

2 bedroom / 1 bath: 975 sq. ft.

3 bedroom / 2 bath: 1130 sq. ft

*\*Example unit in photos; actual unit may vary.*

### Amenities / Utilities

- Washer/Dryer included
- Sink, stove, refrigerator, dishwasher
- All utilities included
- Access to community pool

### Pet Policy

- Maximum 2 pets
- Cats and dogs only (breed restrictions apply)
- \$300 pet fee (\$200 deposit)
- \$35 recurring pet rent
- Licensed and vaccinated



**811  
UNITS**

## **MOUNT ANGELES VIEW**

2408 S Francis St  
Port Angeles, WA 98362



### **About the Building**

**1st Floor:** 8 Units (811)

**2nd Floor:** 2 Units (811)

- 16 stair steps to 2nd floor
- Upper units require a key fob to enter the building.
- Most upper units have a private terrace from the kitchen with water views.



### **About the Unit**

**Unit size:** approximately 580 sq. ft.

Single occupancy only

No smoking in unit

*\*Example unit in photos; actual unit may vary.*

### **Amenities / Utilities**

- Laundry hookup between kitchen and bathroom (washer/dryer not included)
- Sink, stove, refrigerator (dishwasher not included)
- Tenant pays electricity and internet
- PHA pays water, sewer, garbage

### **Pet Policy**

One pet allowed (cat, dog, fish, bird)

\$300 pet deposit (\$100 is non-refundable)

#### **Cats/Dogs**

- Under 25 lbs
- Over one-year-old
- Licensed, vaccinated, and spayed/neutered

#### **Fish**

- Tanks less than 10 gallons
- One fish tank is considered one pet

#### **Birds**

- One bird cage is considered one pet





**811  
UNIT**

## **NUEVA VISTA I & II**

386 N Union St  
Kennewick, WA 99336



### **About the Building**

- 1-bedroom units
  - Nine (9) 811 units
- Two stories
- 18 stair steps to 2nd floor
  - *No elevator access*



### **About the Units**

#### **Unit Sizes**

**Vista I** 1-bedroom: 650 sq. ft.

**Vista II** 1-bedroom: 717 sq. ft

ADA-friendly

*\*Example unit in photos; actual unit may vary.*

### **Amenities / Utilities**

- On-site laundry in each complex (Vista I & II)
- Water / Sewer / Garbage included
- Tenant pays for electricity
- Community center
- Gazebo
- Covered smoking area

### **Pet Policy**

- No pets allowed





# 811 UNIT

**SANTOS PLACE**  
6940 62nd AVE NE  
Seattle, WA 98115



## About the Building

- Now called Sand Point
- Studio Units
  - Eight (8) 811 Units
- All units on main level
- Elevator for mailbox access
- Across Magnuson Park and beach

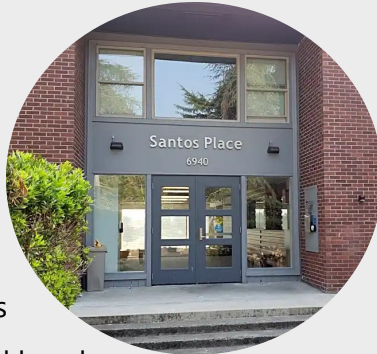

## About the Units

Studio units (*sq. ft. size varies*)

ADA accessible

***\*Ask about a visit to view interior units***

## Amenities / Utilities

- Utilities included
- Coin-operated laundry room
- Community space with recreational items
- On-site case management
- Local food bank on Wednesdays
- Magnuson Park and beach

## Pet Policy

- Only Emotional Support Animals (ESA) and Service pets allowed





# 811 UNIT

## SKYLSTAD HAVEN

301 S 20th Ave  
Pasco, WA 99301



### About the Building

- Studio & 1-Bedroom
- Fifteen (15) 811 Units
- Four stories
- Elevator access
- ADA-friendly units



### About the Units

#### Unit Sizes

Studio: 367 sq. ft.

1-Bedroom Unit: 471 sq. ft.

*\*Example unit in photos; actual unit may vary.*

### Amenities / Utilities

- Laundry room on each floor
- Water/Sewer/Garbage included
- Updated appliances
- Luxury vinyl plank flooring
- Community kitchen & cafeteria
- Outdoor courtyard & garden
- Dog park

### Pet Policy

- Only Emotional Support Animals and Service Animals allowed





**811  
UNIT**

## **SUNSET COURT**

2650 NE 10th St  
Renton, WA 98056



### **About the Building**

- 3 stories
- 1-bedroom units
  - Ten (10) 811 Units
- 17 stair steps to each floor
- Bus line access



### **About the Units**

#### **Unit size:**

**1-bedroom:** 608 sq. ft.

ADA-friendly units

Smoke-free

*\*Example unit in photos; actual unit may vary.*

### **Amenities / Utilities**

- Washer/Dryer in each unit
- Water/Sewer/Garbage included
- Dishwasher, sink, stove
- Outdoor community spaces
- Playground area
- Community garden
- Bike storage

### **Pet Policy**

- No pets allowed





# 811 UNIT

## ST. JUDE'S LANDING

1545 S Mission St  
Wenatchee, WA 98801



### About the Building

- 1, 2, and 3-bedroom units
- Fifteen (15) 811 Units
- Four stories
- Elevator access
- 18 steps between floors



### About the Units

#### Unit Sizes

1 Bedroom: 562 sq. ft.

2 Bedrooms: 1,023 sq. ft

3 Bedrooms: 1,082 sq. ft

ADA-friendly

*\*Example unit in photos; actual unit may vary.*

### Amenities / Utilities

- On-site laundry on each floor
- Water / Sewer / Garbage included
- Tenant pays electricity and internet
- Community room
- Designated smoking areas
- Gated play area

### Pet Policy

- No pets allowed

