

# FIRCREST SCHOOL

## SEC-16 TWN-26 RNG-4 SHORELINE

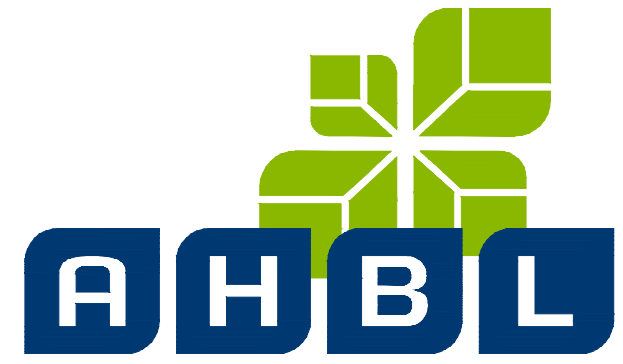

T A C O M A · SEATTLE · SPOKANE · TRI-CITIES  
 1200 6th Avenue, Suite 1620 Seattle, WA 98101  
 206.267.2425 TEL 206.267.2429 FAX www.ahbl.com WEB

Project Title:  
**FIRCREST SCHOOL MASTER DEVELOPMENT PLAN**

Client:

Project No.  
 2180088.10

Issue Set & Date:  
**MASTER DEVELOPMENT PLAN**

**NOTICE**  
 ALTERATION OF THIS DOCUMENT SHALL INVALIDATE THE PROFESSIONAL SEAL AND SIGNATURE. PUBLICATION OF THIS DOCUMENT DOES NOT CONSTITUTE PROFESSIONAL ENGINEERING SERVICE IN THE STATE OF WASHINGTON. THIS DOCUMENT IS THE PROPERTY OF AHBL AND IS NOT TO BE USED FOR OTHER PROJECTS, OR ACCORD TO THAT PROJECT OR FOR ANY OTHER PROJECT.

### NOTES

1. ADD FIRE AND DOMESTIC WATER SERVICE CONNECTIONS TO ALL FUTURE BUILDINGS WITH METERS AND BACKFLOW PREVENTERS AS NECESSARY.
2. WATER CONSTRUCTION SHALL BE IN ACCORDANCE WITH THE CURRENT NORTH CITY UTILITY DISTRICT STANDARD SPECIFICATIONS AND PLANS.
3. PAVEMENT RESTORATION AND OTHER UTILITY CONSTRUCTION SHALL BE IN ACCORDANCE WITH THE CURRENT CITY OF SHORELINE STANDARD SPECIFICATIONS AND PLANS.
4. THE FIRE PROTECTION SYSTEM INCLUDING MATERIALS, SIZING, AND CONFIGURATION IS SUBJECT TO A CONTRACTOR-PROVIDED DESIGN BY FIRE PROTECTION ENGINEER OR A WASHINGTON STATE FIRE MARSHAL LICENSED LEVEL 3 CERTIFICATE OF COMPETENCY HOLDER.
5. DESIGN OF THE FIRE PROTECTION SYSTEM SHOWN IS FOR PLANNING PURPOSES AND MAY DEVIATE FROM THE SYSTEM SHOWN.

### LEGEND

	12" WATER MAIN
	EXISTING WATER MAIN
	FIRE HYDRANT
	FIRE DEPARTMENT CONNECTION
	PROPOSED BUILDING
	PROPOSED BUILDING (BY OTHERS)
	EXISTING BUILDING TO BE DEMOLISHED
	PROPOSED WATER TANK

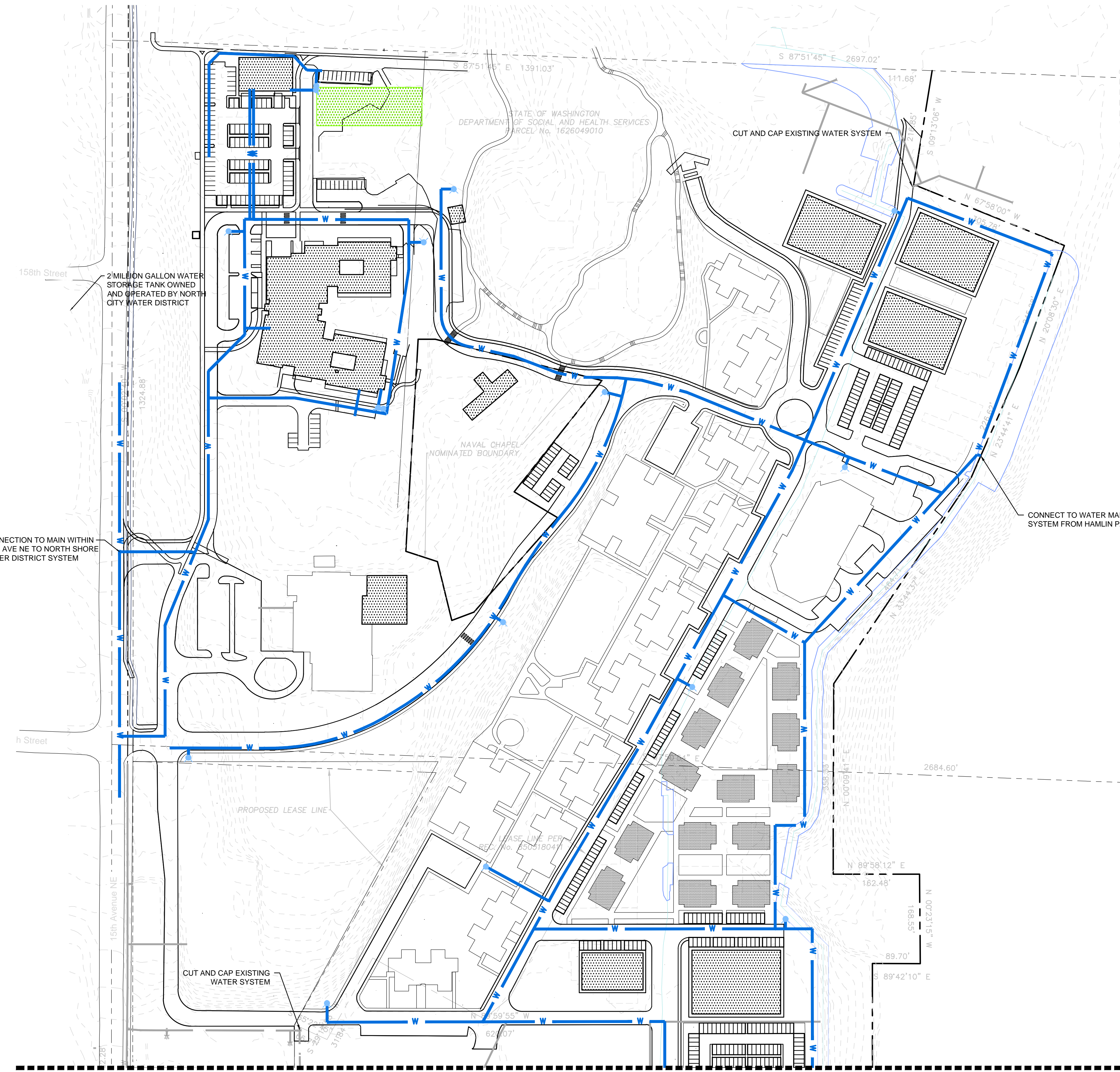

MATCH LINE - 2

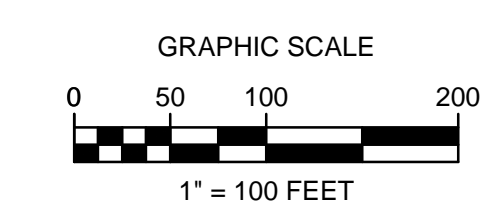
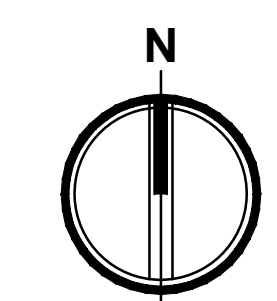

△	_____
△	_____
△	_____
△	_____
Revisions:	

Sheet Title:  
**WATER PLAN NORTH**

Designed by: \_\_\_\_\_ Drawn by: \_\_\_\_\_ Checked by: \_\_\_\_\_

Sheet No. \_\_\_\_\_



# FIRCREST SCHOOL

MATCH LINE - 1 SEC-16 TWN-26 RNG-4 SHORELINE

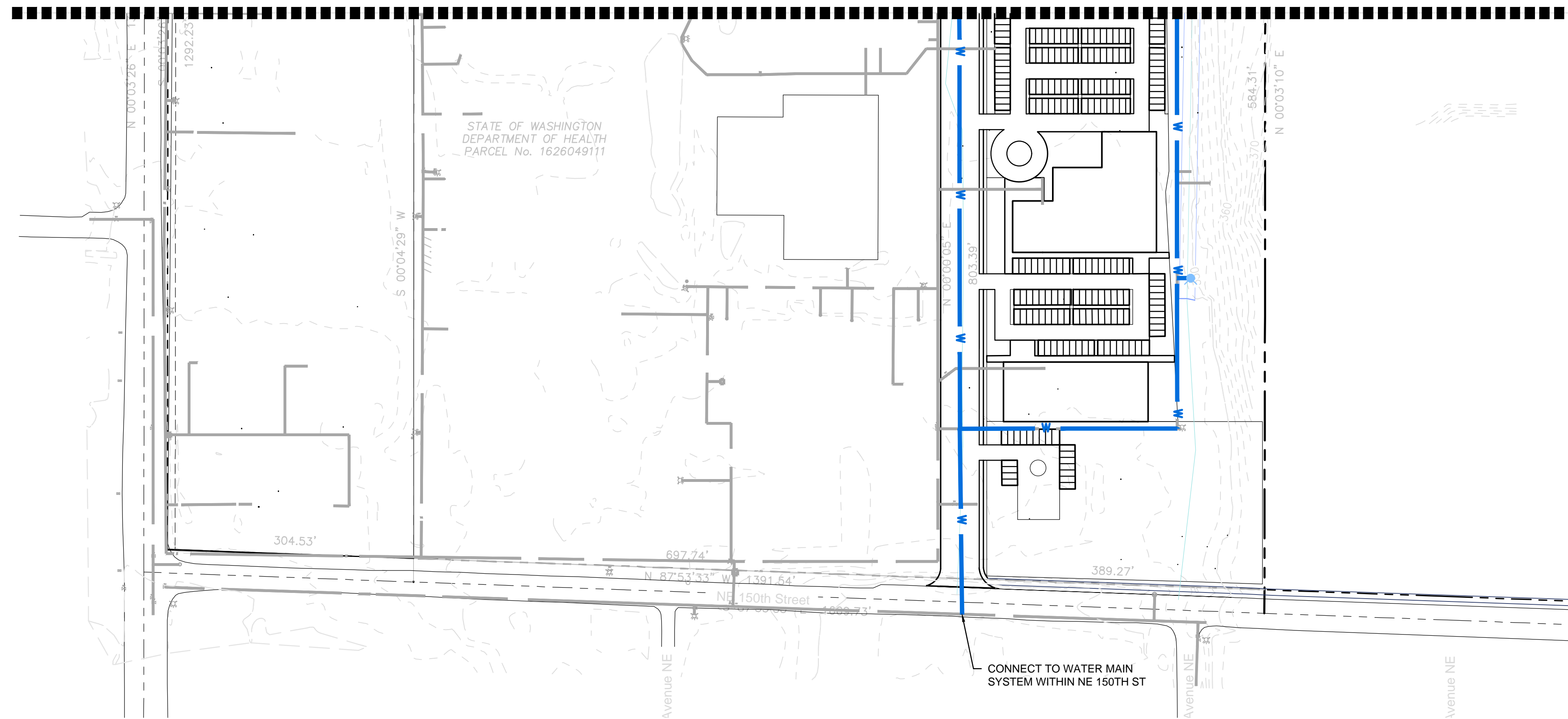

## NOTES

1. ADD FIRE AND DOMESTIC WATER SERVICE CONNECTIONS TO ALL FUTURE BUILDINGS WITH METERS AND BACKFLOW PREVENTERS AS NECESSARY.
2. WATER CONSTRUCTION SHALL BE IN ACCORDANCE WITH THE CURRENT NORTH CITY UTILITY DISTRICT STANDARD SPECIFICATIONS AND PLANS.
3. PAVEMENT RESTORATION AND OTHER UTILITY CONSTRUCTION SHALL BE IN ACCORDANCE WITH THE CURRENT CITY OF SHORELINE STANDARD SPECIFICATIONS AND PLANS.
4. THE FIRE PROTECTION SYSTEM INCLUDING MATERIALS, SIZING, AND CONFIGURATION IS SUBJECT TO A CONTRACTOR-PROVIDED DESIGN BY FIRE PROTECTION ENGINEER OR A WASHINGTON STATE FIRE MARSHAL LICENSED LEVEL 3 CERTIFICATE OF COMPETENCY HOLDER.
5. DESIGN OF THE FIRE PROTECTION SYSTEM SHOWN IS FOR PLANNING PURPOSES AND MAY DEVIATE FROM THE SYSTEM SHOWN.

## LEGEND

	12" WATER MAIN
	EXISTING WATER MAIN
	FIRE HYDRANT
	FIRE DEPARTMENT CONNECTION
	PROPOSED BUILDING
	PROPOSED BUILDING (BY OTHERS)
	EXISTING BUILDING TO BE DEMOLISHED
	PROPOSED WATER TANK

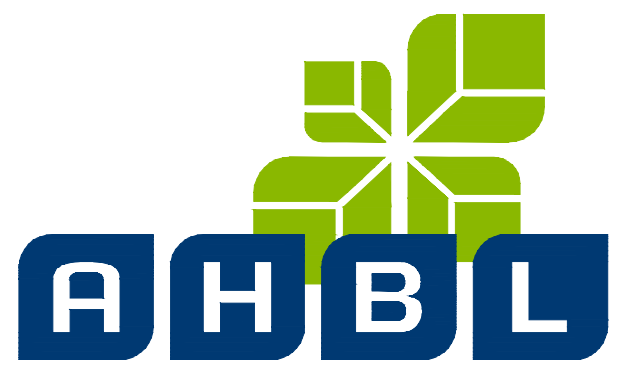

T A C O M A · SEATTLE · SPOKANE · TRI-CITIES

1200 6th Avenue, Suite 1620 Seattle, WA 98101  
206.267.2425 TEL 206.267.2429 FAX www.ahbl.com WEB

Project Title:  
**FIRCREST SCHOOL MASTER DEVELOPMENT PLAN**

Client:

Project No.  
2180088.10

Issue Set & Date:  
**MASTER DEVELOPMENT PLAN**

**NOTICE**  
ALTERATION OF THIS DOCUMENT SHALL INVALIDATE THE PROFESSIONAL SEAL AND SIGNATURE. PUBLICATION OF THIS DOCUMENT DOES NOT CONSTITUTE PROFESSIONAL ENGINEERING SERVICE BY THE ENGINEER OF THE USE ONLY FOR THE PROJECT DESCRIBED IN THIS BLOCK AND IS NOT TO BE USED FOR OTHER PROJECTS OR ACCORD TO THAT PROJECT OR FOR ANY OTHER PROJECT.

△	_____
△	_____
△	_____
△	_____
Revisions:	_____

Sheet Title:  
**WATER PLAN SOUTH**

Designed by: \_\_\_\_\_ Drawn by: \_\_\_\_\_ Checked by: \_\_\_\_\_

Sheet No.

**2**

of 6 Sheets

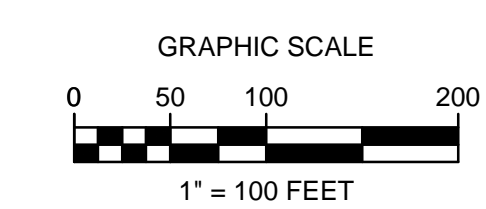
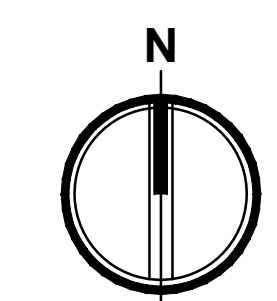



# FIRCREST SCHOOL

## SEC-16 TWN-26 RNG-4 SHORELINE

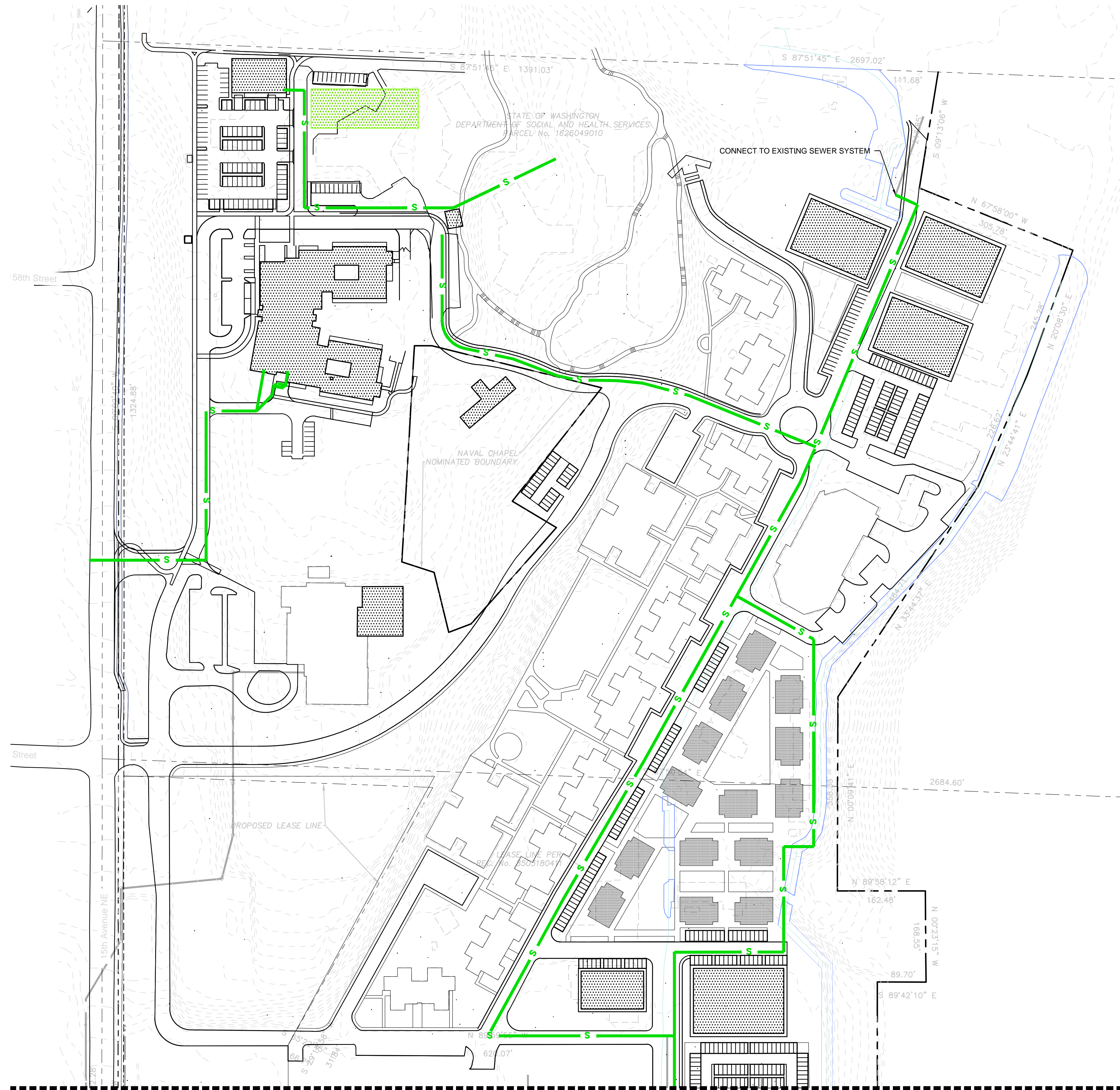

### NOTES

1. SIDE SEWER SERVICE CONNECTIONS SHALL BE MADE TO ALL FUTURE BUILDINGS WITH BACKFLOW PREVENTERS AS NECESSARY.
2. SEWER CONSTRUCTION SHALL BE IN ACCORDANCE WITH THE CURRENT CITY OF SHORELINE STANDARD SPECIFICATIONS AND PLANS.
3. PAVEMENT RESTORATION AND OTHER UTILITY CONSTRUCTION SHALL BE IN ACCORDANCE WITH THE CURRENT CITY OF SHORELINE STANDARD SPECIFICATIONS AND PLANS.
4. DESIGN OF THE SEWER SYSTEM SHOWN IS FOR PLANNING PURPOSES AND MAY DEVIATE FROM THE SYSTEM SHOWN.

### LEGEND

	PROPOSED SEWER MAIN
	EXISTING SEWER MAIN
	PROPOSED BUILDING
	PROPOSED BUILDING (BY OTHERS)
	EXISTING BUILDING TO BE DEMOLISHED
	PROPOSED WATER TANK



T A C O M A · SEATTLE · SPOKANE · TRI-CITIES  
 1200 6th Avenue, Suite 1620 Seattle, WA 98101  
 206.267.2425 TEL 206.267.2429 FAX www.ahbl.com WEB

Project Title:  
**FIRCREST SCHOOL MASTER DEVELOPMENT PLAN**

Client:

Project No.  
 2180088.10

Issue Set & Date:  
 MASTER DEVELOPMENT PLAN

**NOTICE**  
 ALTERATION OF THIS DOCUMENT SHALL MAINTAIN THE PROFESSIONAL SEAL AND SIGNATURE. PUBLICATION OF THIS DOCUMENT DOES NOT CONSTITUTE PROFESSIONAL ENGINEERING SERVICE BY THE ENGINEER OF THE DESIGN ONLY FOR THE PROJECT DESCRIBED IN THE TITLE BLOCK AND IS NOT TO BE USED FOR OTHER PURPOSES OR ACCORD TO THAT PROJECT OR FOR ANY OTHER PROJECT.

△	_____
△	_____
△	_____
△	_____
△	_____

Revisions:

Sheet Title:  
**SEWER PLAN NORTH**

Designed by: \_\_\_\_\_ Drawn by: \_\_\_\_\_ Checked by: \_\_\_\_\_

Sheet No.

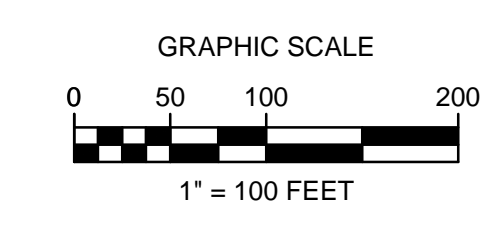
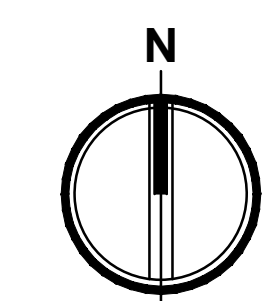



# FIRCREST SCHOOL

## SEC-16 TWN-26 RNG-4 SHORELINE

MATCH LINE - 3

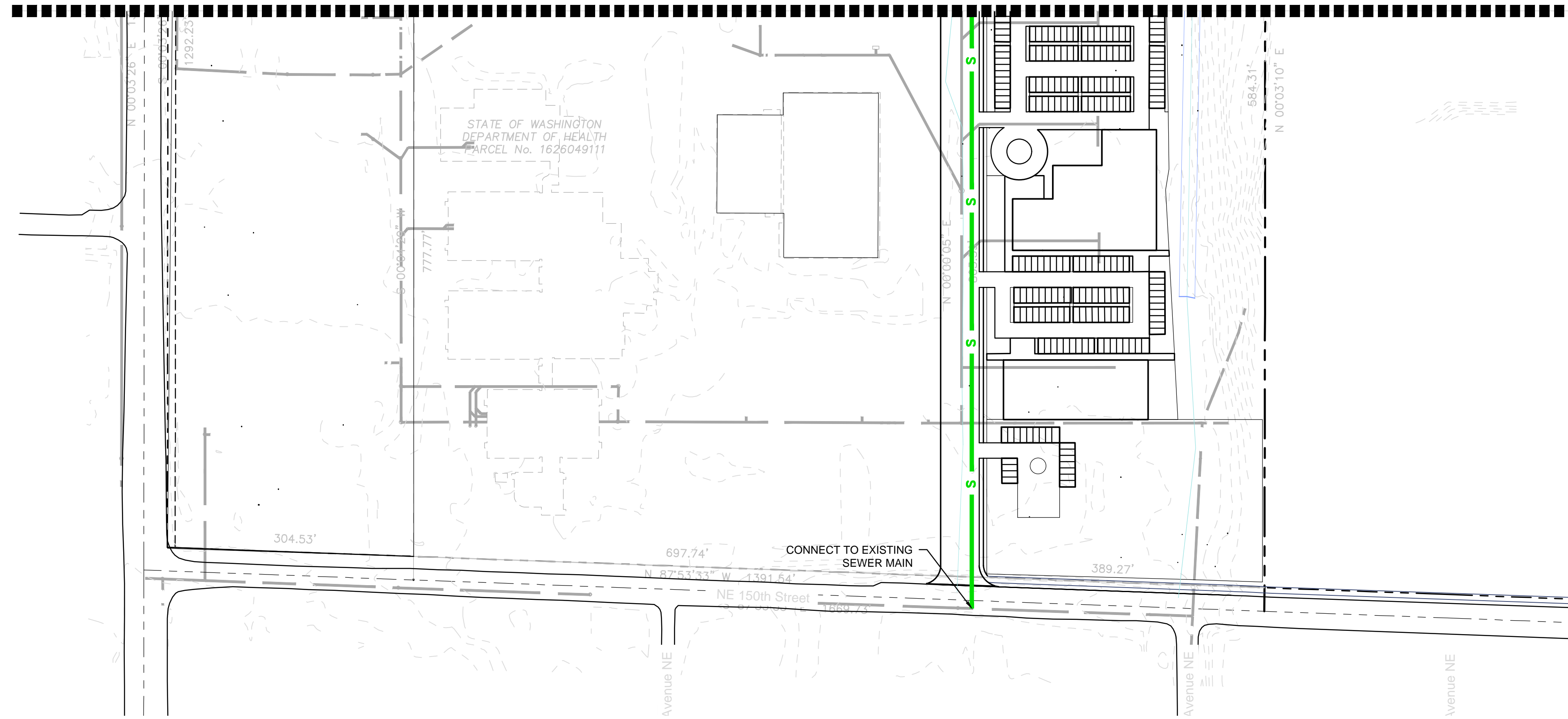

### NOTES

1. SIDE SEWER SERVICE CONNECTIONS SHALL BE MADE TO ALL FUTURE BUILDINGS WITH BACKFLOW PREVENTERS AS NECESSARY.
2. SEWER CONSTRUCTION SHALL BE IN ACCORDANCE WITH THE CURRENT CITY OF SHORELINE STANDARD SPECIFICATIONS AND PLANS.
3. PAVEMENT RESTORATION AND OTHER UTILITY CONSTRUCTION SHALL BE IN ACCORDANCE WITH THE CURRENT CITY OF SHORELINE STANDARD SPECIFICATIONS AND PLANS.
4. DESIGN OF THE SEWER SYSTEM SHOWN IS FOR PLANNING PURPOSES AND MAY DEVIATE FROM THE SYSTEM SHOWN.

### LEGEND

	PROPOSED SEWER MAIN
	EXISTING SEWER MAIN
	PROPOSED BUILDING
	PROPOSED BUILDING (BY OTHERS)
	EXISTING BUILDING TO BE DEMOLISHED
	PROPOSED WATER TANK



T A C O M A · SEATTLE · SPOKANE · TRI-CITIES

1200 6th Avenue, Suite 1620 Seattle, WA 98101  
206.267.2425 TEL 206.267.2429 FAX www.ahbl.com WEB

Project Title:  
FIRCREST SCHOOL MASTER DEVELOPMENT PLAN

Client:

Project No.  
2180088.10

Issue Set & Date:  
MASTER DEVELOPMENT PLAN

**NOTICE**  
ALTERATION OF THIS DOCUMENT SHALL INVALIDATE THE PROFESSIONAL SEAL AND SIGNATURE. PUBLICATION OF THIS DOCUMENT DOES NOT REPRESENT THE DESIGNER'S RESPONSIBILITY FOR THE DESIGN OR THE USE ONLY FOR THE PROJECT SPECIFIED IN THIS BLOCK AND IS NOT TO BE USED FOR OTHER PROJECTS OR ACCORD TO THAT PROJECT OR FOR ANY OTHER PROJECT.

Revisions:

△	_____
△	_____
△	_____
△	_____

Sheet Title:  
SEWER PLAN SOUTH

Designed by: Drawn by: Checked by:

Sheet No.

4

of 6 Sheets

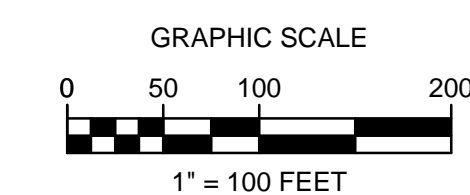
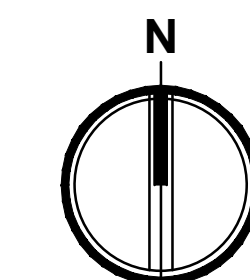

Know what's below.  
Call before you dig.



# FIRCREST SCHOOL

## SEC-16 TWN-26 RNG-4 SHORELINE



T A C O M A · SEATTLE · SPOKANE · TRI-CITIES

1200 6th Avenue, Suite 1620 Seattle, WA 98101  
206.267.2425 TEL 206.267.2429 FAX www.ahbl.com WEB

Project Title:  
**FIRCREST SCHOOL MASTER DEVELOPMENT PLAN**

Client:

Project No.  
2180088.10

Issue Set & Date:  
**MASTER DEVELOPMENT PLAN**

**NOTICE**  
ALTERATION OF THIS DOCUMENT SHALL INVALIDATE THE PROFESSIONAL SEAL AND SIGNATURE. PUBLICATION OF THIS DOCUMENT DOES NOT CONSTITUTE PROFESSIONAL ENGINEERING SERVICE IN THE STATE OF WASHINGTON. THIS DOCUMENT IS THE PROPERTY OF AHBL AND IS NOT TO BE USED FOR OTHER PROJECTS OR ACCORD TO THAT PROJECT OR FOR ANY OTHER PROJECT.

### NOTES

- ALL WORK SHALL COMPLY WITH, IN ORDER OF PRECEDENCE: \* THE CITY OF SHORELINE "ENGINEERING DEVELOPMENT MANUAL", 2022 EDITION (SHORELINE STANDARDS AND SHORELINE ENGINEERING DETAILS). \* WSDOT/APWA "2022 STANDARD SPECIFICATIONS FOR ROAD, BRIDGE, AND MUNICIPAL CONSTRUCTION" (WSDOT/APWA).
- PAVEMENT RESTORATION AND OTHER UTILITY CONSTRUCTION SHALL BE IN ACCORDANCE WITH THE CURRENT CITY OF SHORELINE ENGINEERING DEVELOPMENT MANUAL.
- PROVIDE CATCH BASINS AND AREA DRAINS PER CITY OF SHORELINE ENGINEERING DEVELOPMENT MANUAL AND WSDOT STANDARDS AS NEEDED TO CAPTURE DRAINAGE AND MITIGATE STORMWATER.
- PROVIDE ROOF DRAIN AND FOOTING DRAIN AT ALL NEW BUILDINGS.
- DESIGN OF STORMWATER DRAINAGE SHOWN IS FOR PLANNING PURPOSES AND MAY DEVIATE FROM THE SYSTEM SHOWN.

### LEGEND

	STORM DRAIN
	EXISTING STORM DRAIN
	FLOW CONTROL TANK OR VAULT
	WATER QUALITY TREATMENT STRUCTURE
	BIORETENTION CELL OR ONSITE STORMWATER MANAGEMENT
	EXISTING 10' CONTOUR
	PROPOSED BUILDING
	PROPOSED BUILDING (BY OTHERS)
	EXISTING BUILDING
	PROPOSED WATER TANK

### KEYNOTES

- ① CONNECT TO EXISTING STORM DRAINAGE SYSTEM.



MATCH LINE - 6

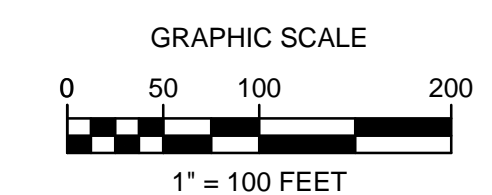
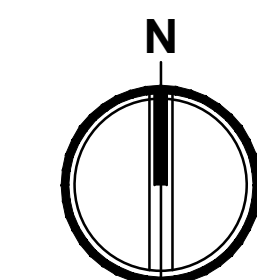

Know what's below.  
Call before you dig.

Revisions:

Sheet Title:  
**STORM PLAN NORTH**

Designed by: Drawn by: Checked by:

Sheet No.



# FIRCREST SCHOOL

## SEC-16 TWN-26 RNG-4 SHORELINE

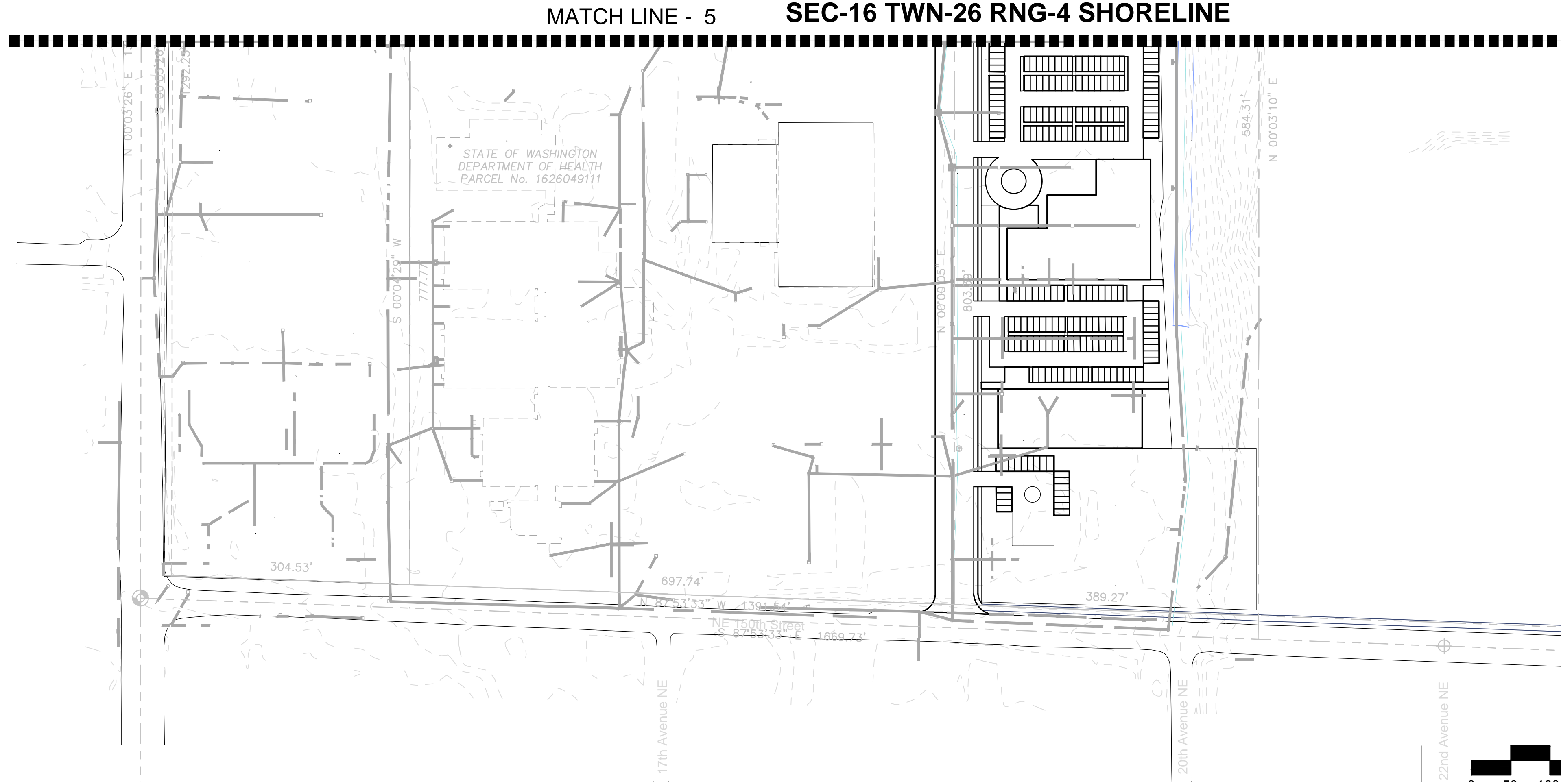

### NOTES

- ALL WORK SHALL COMPLY WITH, IN ORDER OF PRECEDENCE: \* THE CITY OF SHORELINE "ENGINEERING DEVELOPMENT MANUAL", 2022 EDITION (SHORELINE STANDARDS AND SHORELINE ENGINEERING DETAILS). \* WSDOT/APWA "2022 STANDARD SPECIFICATIONS FOR ROAD, BRIDGE, AND MUNICIPAL CONSTRUCTION" (WSDOT/APWA).
- PAVEMENT RESTORATION AND OTHER UTILITY CONSTRUCTION SHALL BE IN ACCORDANCE WITH THE CURRENT CITY OF SHORELINE ENGINEERING DEVELOPMENT MANUAL.
- PROVIDE CATCH BASINS AND AREA DRAINS PER CITY OF SHORELINE ENGINEERING DEVELOPMENT MANUAL AND WSDOT STANDARDS AS NEEDED TO CAPTURE DRAINAGE AND MITIGATE STORMWATER.
- PROVIDE ROOF DRAIN AND FOOTING DRAIN AT ALL NEW BUILDINGS.
- DESIGN OF STORMWATER DRAINAGE SHOWN IS FOR PLANNING PURPOSES AND MAY DEVIATE FROM THE SYSTEM SHOWN.

### LEGEND

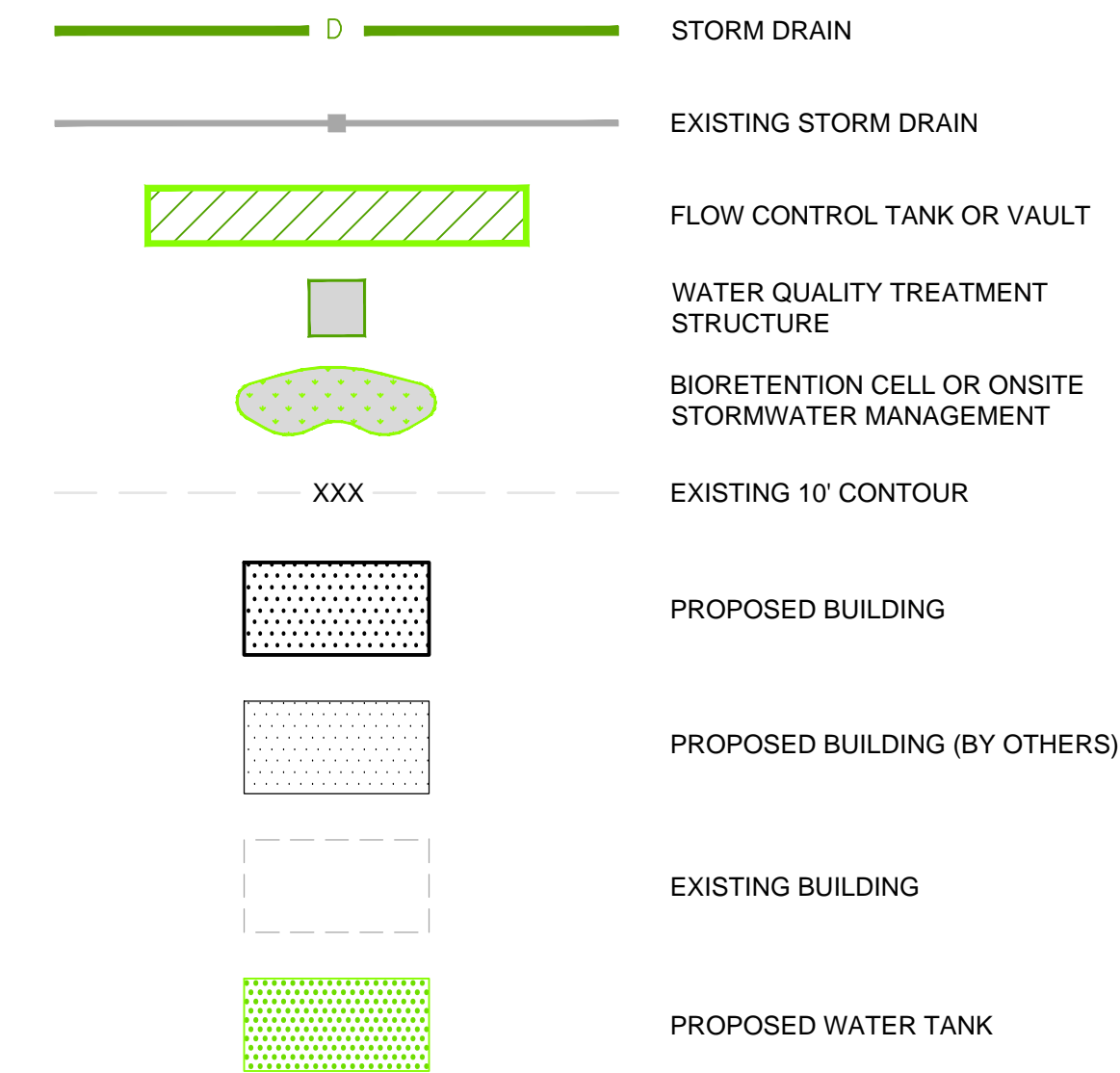

### KEYNOTES

- CONNECT TO EXISTING STORM DRAINAGE SYSTEM.

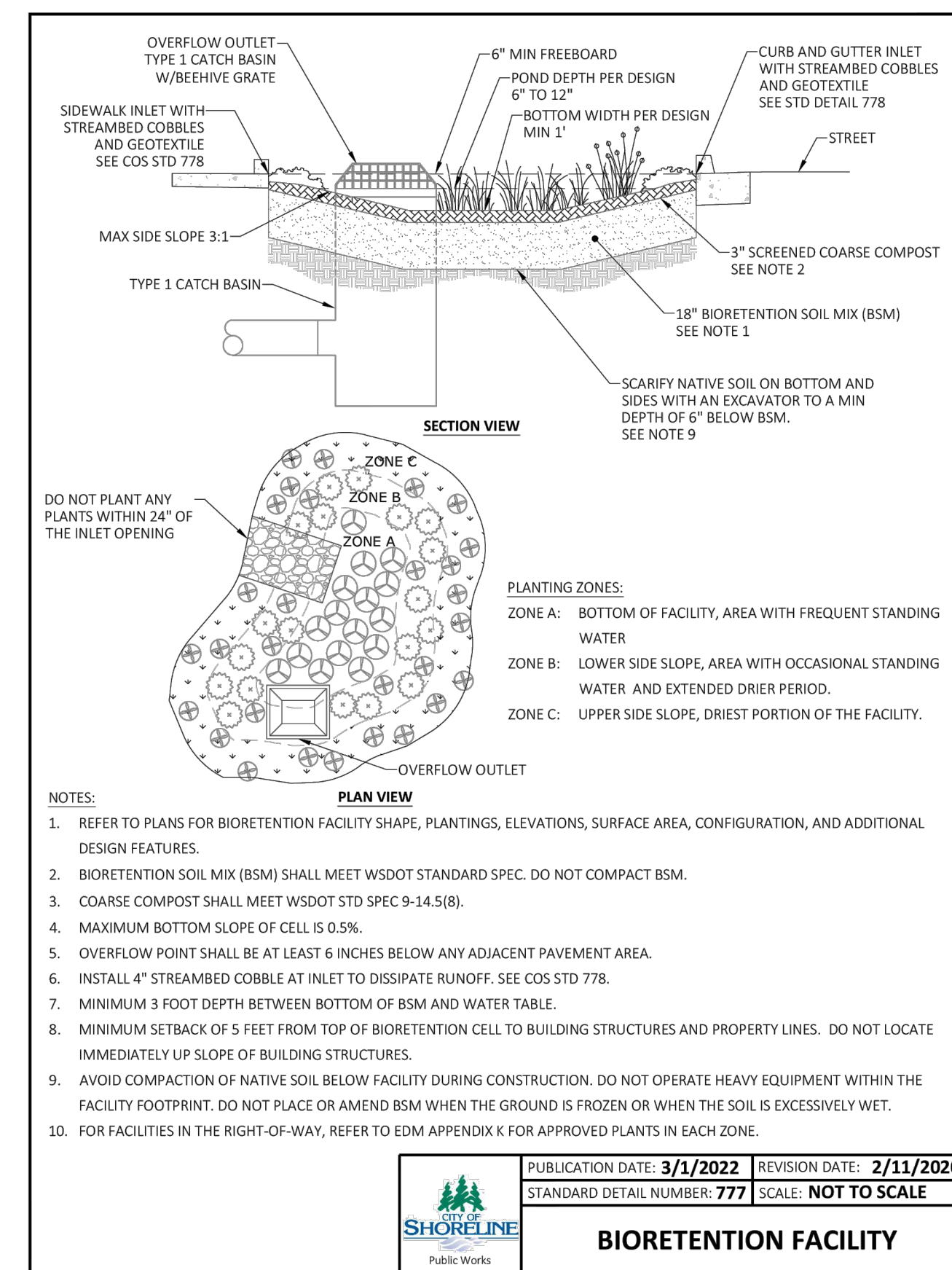
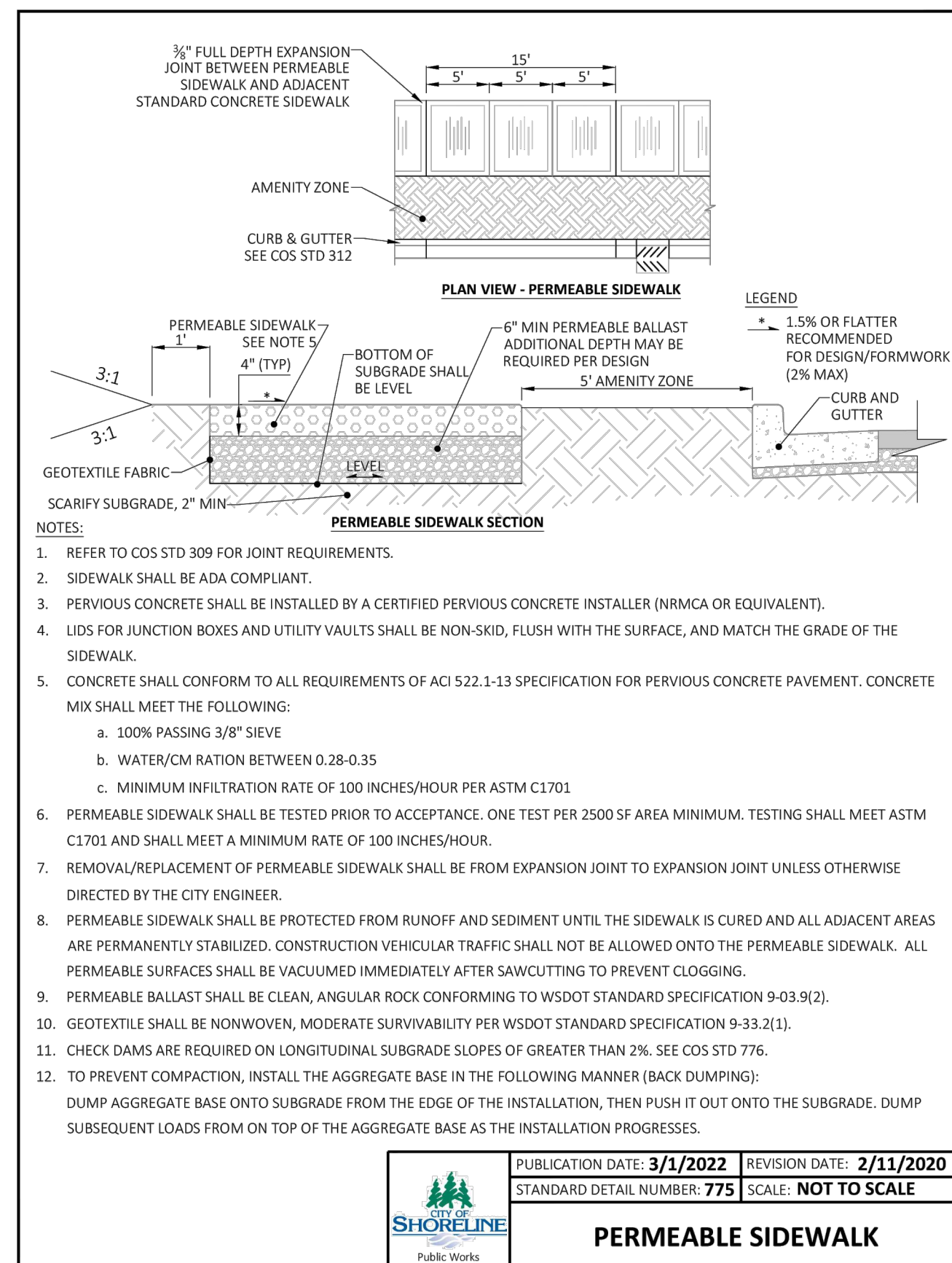

**NOTICE**  
ALTERATION OF THIS DOCUMENT SHALL INVALIDATE THE PROFESSIONAL SEAL AND SIGNATURE. PUBLICATION OF THIS DOCUMENT DOES NOT CONSTITUTE PROFESSIONAL ENGINEERING DESIGN OR THE GUARANTEE OF THE DESIGN ONLY FOR THE PROJECT DESCRIBED IN THIS BLOCK AND IS NOT TO BE USED FOR OTHER PROJECTS OR ACCORD TO THAT PROJECT OR FOR ANY OTHER PROJECT.



T A C O M A · SEATTLE · SPOKANE · TRI-CITIES

1200 6th Avenue, Suite 1620 Seattle, WA 98101  
206.267.2425 TEL 206.267.2429 FAX www.ahbl.com WEB

Project Title:  
**FIRCREST SCHOOL MASTER DEVELOPMENT PLAN**

Client:

Project No.  
2180088.10

Issue Set & Date:  
**MASTER DEVELOPMENT PLAN**

Revisions:

Sheet Title:  
**STORM PLAN SOUTH**

Designed by: Drawn by: Checked by:

Sheet No.

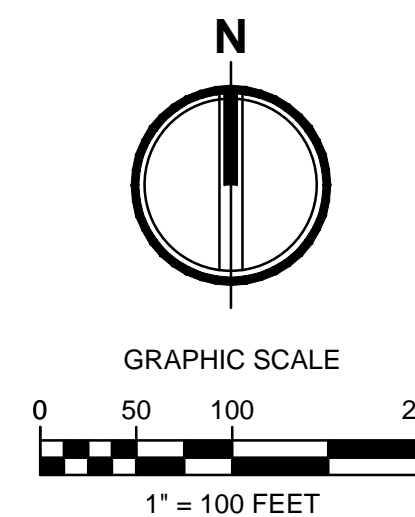

### ONSITE STORMWATER MANAGEMENT FACILITIES

NOTE: IMPLEMENTATION OF FACILITIES SHALL ADHERE TO CITY OF SHORELINE ENGINEERING DEVELOPMENT STANDARDS AND DEPARTMENT OF ECOLOGY STORMWATER MANUAL. FACILITIES TO INCLUDE BUT NOT LIMITED TO PERMEABLE SIDEWALK AND BIORETENTION CELLS SHOW IN DETAIL.